

Central transmission 中央变速箱操作指南(附加页)

OPERATING INSTRUCTIONS P10-044B

Different power outputs can be achieved by flipping the shift switch.

通过拨动换挡开关，实现不同的动力输出。

CH7, Shift switch
CH7换挡开关



Low speed 低速



Neutral 空档



High speed 高速

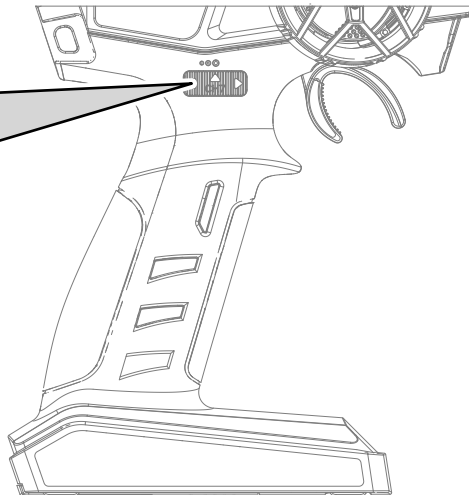

Low speed
低速

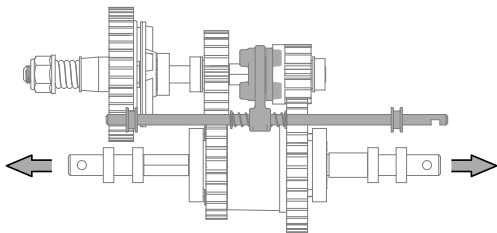

The center differential is running
中央差速器运行

Neutral
空档

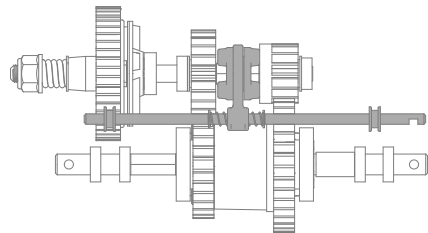

No output
无输出

High speed
高速

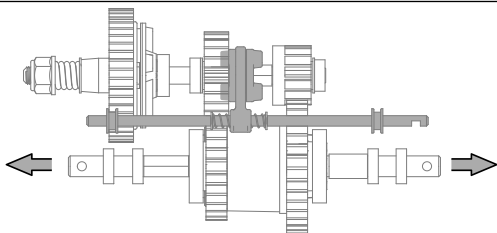

The center differential is running
中央差速器运行

Installation of central transmission 中央变速箱的安装

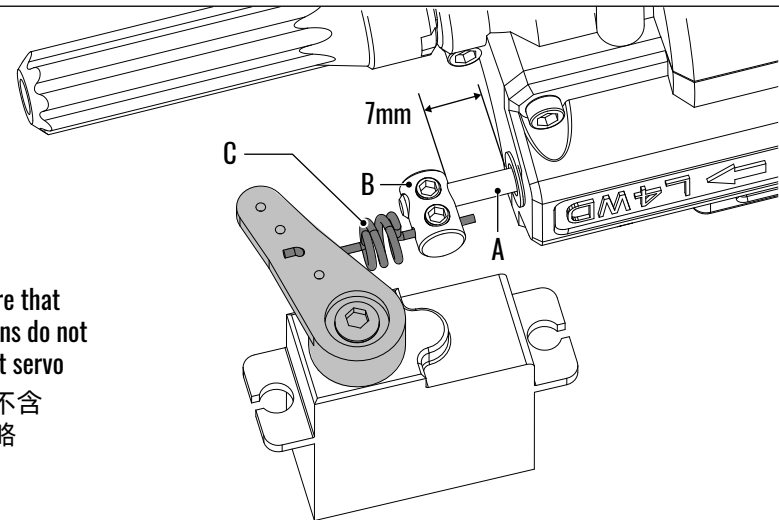

Please ignore that some versions do not contain shift servo
部分版本不含挂挡请忽略

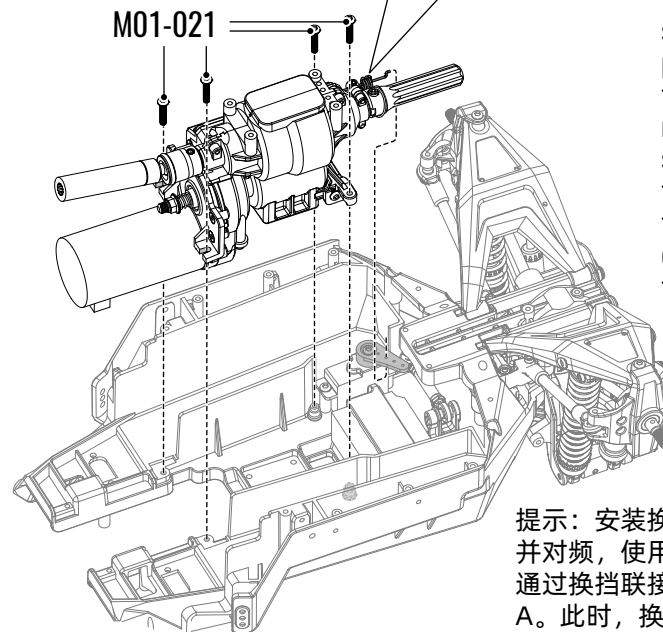

Tips: When installing the shift draw spring assembly, please turn on the power and frequency first, use the transmitter to switch the driving mode to 'Neutral', and fix the shift spring C and shifting shaft A through the shifting coupling sleeve B. At this time, the distance between the shift coupling sleeve and the central transmission housing is about 7 mm.

提示：安装换挡拉簧组件时，请先接通电源并对频，使用遥控器将驱动模式切换至空挡，通过换挡联接套B固定好换挡拉簧C和换挡轴A。此时，换挡联接套与中央变速器外壳的间距约为7mm。

Central transmission assembly

Accessories vary by model, the products obtained from sales shall prevail.

中央变速箱总成

各零配件以销售所得为准

P10-044B

